

# GoboTop, the Mini-Projector

Thank you for purchasing this high-quality product. GoboTop is exclusively manufactured in Germany and meets the highest quality and safety standards. We are confident that you will be amazed by the crisp projections produced by this tiny but versatile projector. Please read these operating instructions first in order to use the system effectively and safely!



### Important Safety Note



Additional tip(s) for the most effective use of your Mini-Projector.

1

## A) Safety precautions:

- GoboTop is only suitable for dry indoor locations.
- Use only replacement lamps that are tested and approved by Derksen Lichttechnik (see section 12). If you operate GoboTop with an unsuitable lamp, the system will be damaged.
- Projection head, lamp, socket and fixture heat up during operation. Wait approx. 15 minutes until the system has cooled down before you handle gobo, lamp, projection head or fixture.
- Observe a minimum distance of 0.5 m between the projection head and any flammable materials or surfaces.
- Do not cover the rear side of the lamp in order to avoid accumulation of heat.
- Please make sure that your Halogen low voltage system supports 12V, 30/50W.



2



- Only use original accessories made by Derksen Lichttechnik which are specially designed to be used with GoboTop. When using incompatible accessories from other manufacturers, injury to persons or damage to property may result.
- Ensure that the GoboTop - Mini-Projector is firmly attached to your halogen lighting system. The multi-mirror lamp must be completely inserted into the socket.
- It is obligatory to attach the enclosed safety cable which may retain the projector (please refer to chapter C in section 11).

#### How to use the safety cable:

- Wrap the safety cable around a rail or any similar part of your halogen lighting system. Push the cable through the eyelet in order to close the loop.
- Attach the hook to one of the four eyelets on the fastening ring (1, 2).

3

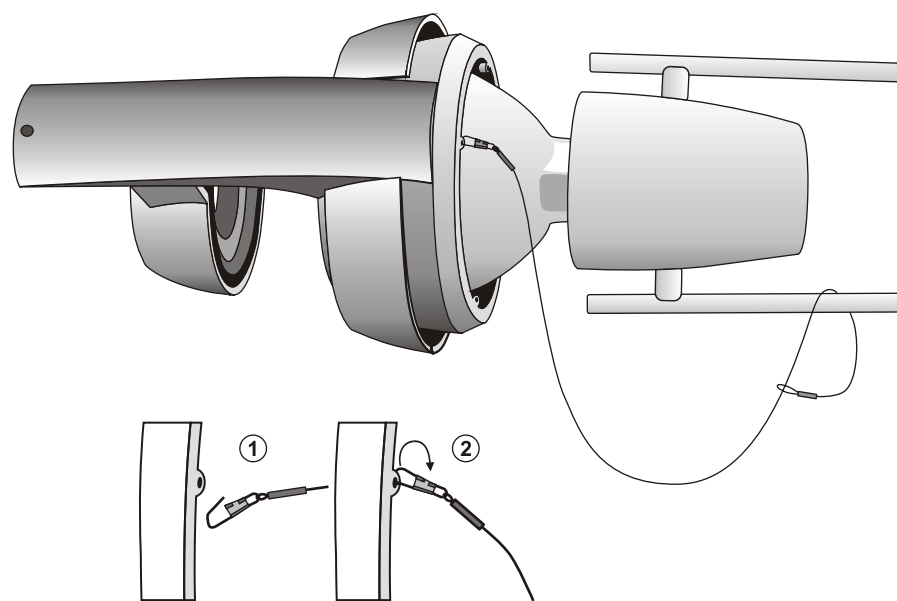

4

## B) Assembly:

### GoboTop parts:

- |                            |                                    |                                   |
|----------------------------|------------------------------------|-----------------------------------|
| <b>1</b> focussing rail    | <b>2</b> lens                      | <b>3</b> light shield             |
| <b>4</b> housing           | <b>5</b> gobo                      | <b>6</b> spacer ring              |
| <b>7</b> multi-mirror lamp | <b>8</b> fastening Ring (threaded) | <b>9</b> eyelets for safety cable |

5

### Step-by-step assembly:

1. Remove the multi-mirror lamp.
2. Remove the fastening ring (8) by turning it counter-clockwise.
3. Remove the spacer ring (6).
4. Insert the gobo and arrange the image.

In order to arrange the image properly follow the steps below:

- The image should be visible/readable from the lamp (see illustration below, item 5) and should be turned upside down.
  - If a deflection mirror is used, please follow the installation tip in section 9.
5. Re-insert the spacer ring (6).
  6. Place the multi-mirror lamp (7) on the spacer ring (6).
  7. Tighten the fastening ring.



6

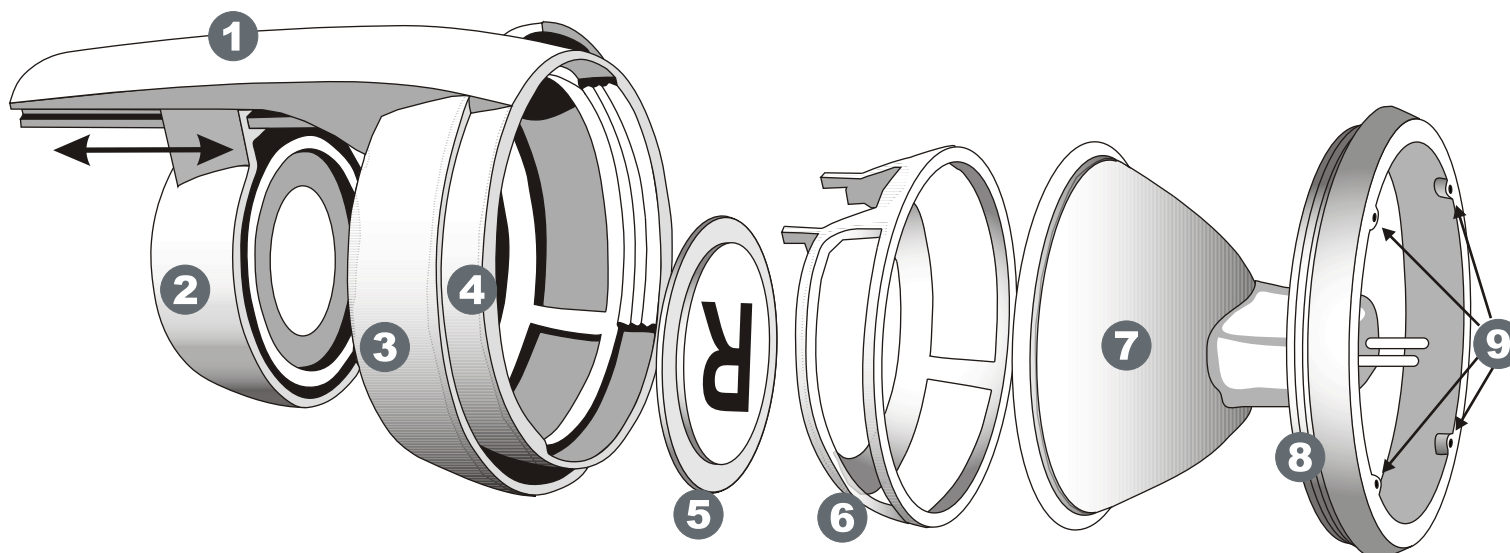

7

8

**Installation of the optional deflection mirror (see illustration section 10):**

1. Remove the splint located at the tip of the focussing rail and retain it for future use.
2. Insert the deflection mirror by pressing it into the focussing rail. Please be sure that the latch engages and the mirror is firmly locked in place.
3. The angle of the mirror is 45°. Focus the image by moving the lens on the focussing rail until you achieve a sharp image. Arrange the image on the projection surface by turning the complete fixture.

Please note that the image will be mirror-inverted if a deflection mirror is used. The image on the gobo should be mirror-inverted on the side of the lamp and should not be upside down.

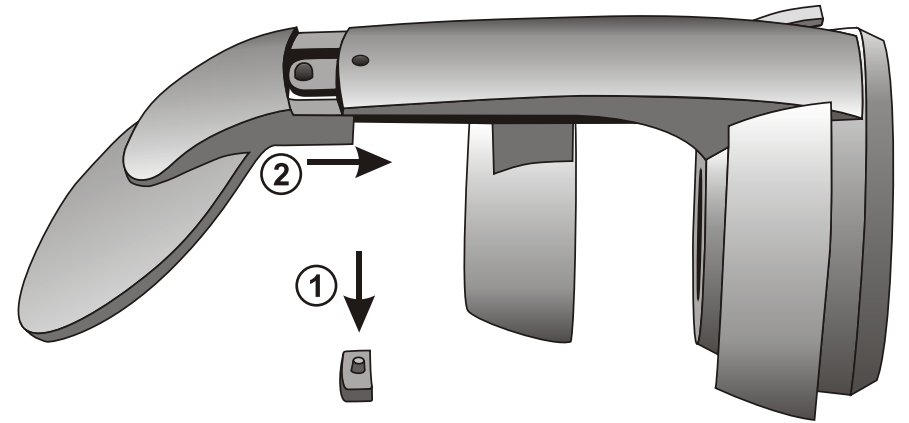

**C) Attaching GoboTop to a low voltage halogen lighting system:**

Attaching the Mini-Projector to a commercially available halogen low voltage system does not require any tools.

1. Carefully attach the assembled GoboTop with the multi-mirror lamp to the fixture and make sure that the lamp is completely inserted into the socket.
  - Only attach GoboTop to halogen lighting systems that are able to hold the projector firmly and safely. Injury to persons or damage to property may result if GoboTop drops down.
  - Only use halogen lighting systems where you can install the included safety cable (see illustration, section 4).
2. Adjust the projected image by moving the entire fixture with the attached projector assembly.
3. Focus the image by moving the lens (2) on the focussing rail (1), see also illustration in section 7/8.



**D) Technical Specifications:**

- Type: GoboTop Mini-Projector
- Manufacturer: Derksen Lichttechnik GmbH
- Lamp: Type MR16: 12V, 35W or 50W (max)  
Use only lamps tested and approved by Derksen Lichttechnik!
- Minimum distance from flammable materials or surfaces: 0.5 m (ca. 20")
- Weight: 88 g (3.1 oz.) incl. multi-mirror lamp

**Multi-mirror lamps approved and recommended by Derksen Lichttechnik:**

- Philips Brilliant Line Pro 12 Volt, 35/50 Watt, 24°
- BLV Eurostar 12 Volt, 35/50 Watt, 24°
- Osram Dekostar Titan 12 Volt, 35/50 Watt, 24°
- Sylvania Superia 12 Volt, 35/50 Watt, 24°

The lamp should have a beam angle of 24° for optimum performance.

Suitable replacement lamps and accessories can be ordered directly from Derksen Lichttechnik.



**Image size with increasing projection distance:**

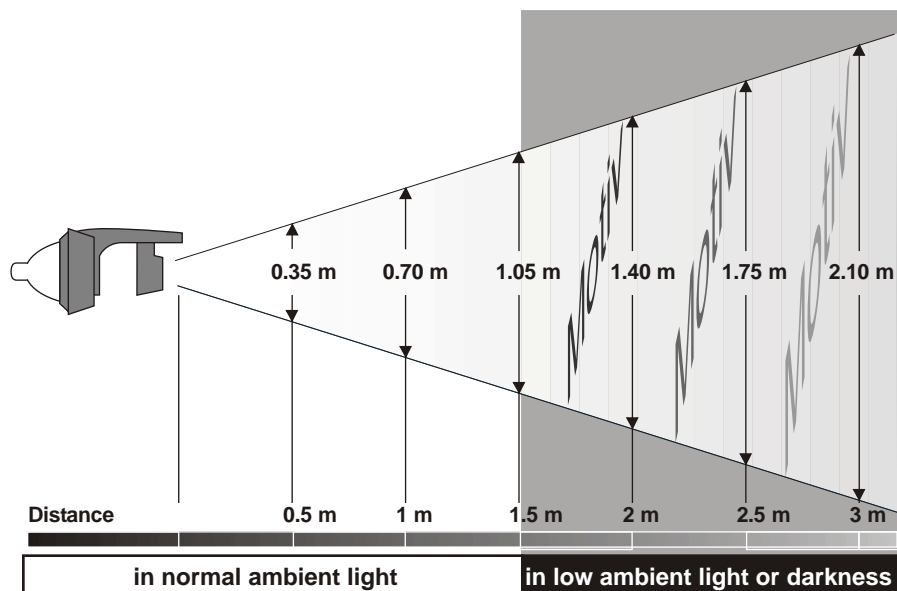

**F) Glass gobos made by Derksen**

We use cutting-edge technology to prepare every gobo to meet each customer's special needs. Our laser-based manufacturing process guarantees optimal precision, resolution and brilliance. On this basis, we create quality gobos that bring our customers' visions to life.

You can deliver your artwork in any common file format via e-mail. We'll then prepare it based on your specific parameters and laser process your gobo to perfection.

**E) Warranty:**

Derksen Lichttechnik GmbH warrants this product, the GoboTop and all available accessories, to be in a good working order during a period of 2 years from the date of purchase. Consumable parts, i. e. multi-mirror lamps, are excluded from warranty. Lamps must be replaced from time to time, depending on operation periods. Warranty repair service is excluded if damage or defects have been caused by improper use, incorrect storage, repairs, modifications or cleaning by unqualified technicians, not authorized by Derksen.

**GoboTop  
Operating Instructions**

**derksen®**  
lichttechnik

Derksen Lichttechnik GmbH  
Sauerlandstrasse 5  
45889 Gelsenkirchen, Germany

Tel.: +49(0)2 09 / 9 80 70-0  
Fax: +49(0)2 09 / 9 80 70-60

E-Mail: info@derksen.de  
www.derksen.de